

FORM NO 1.

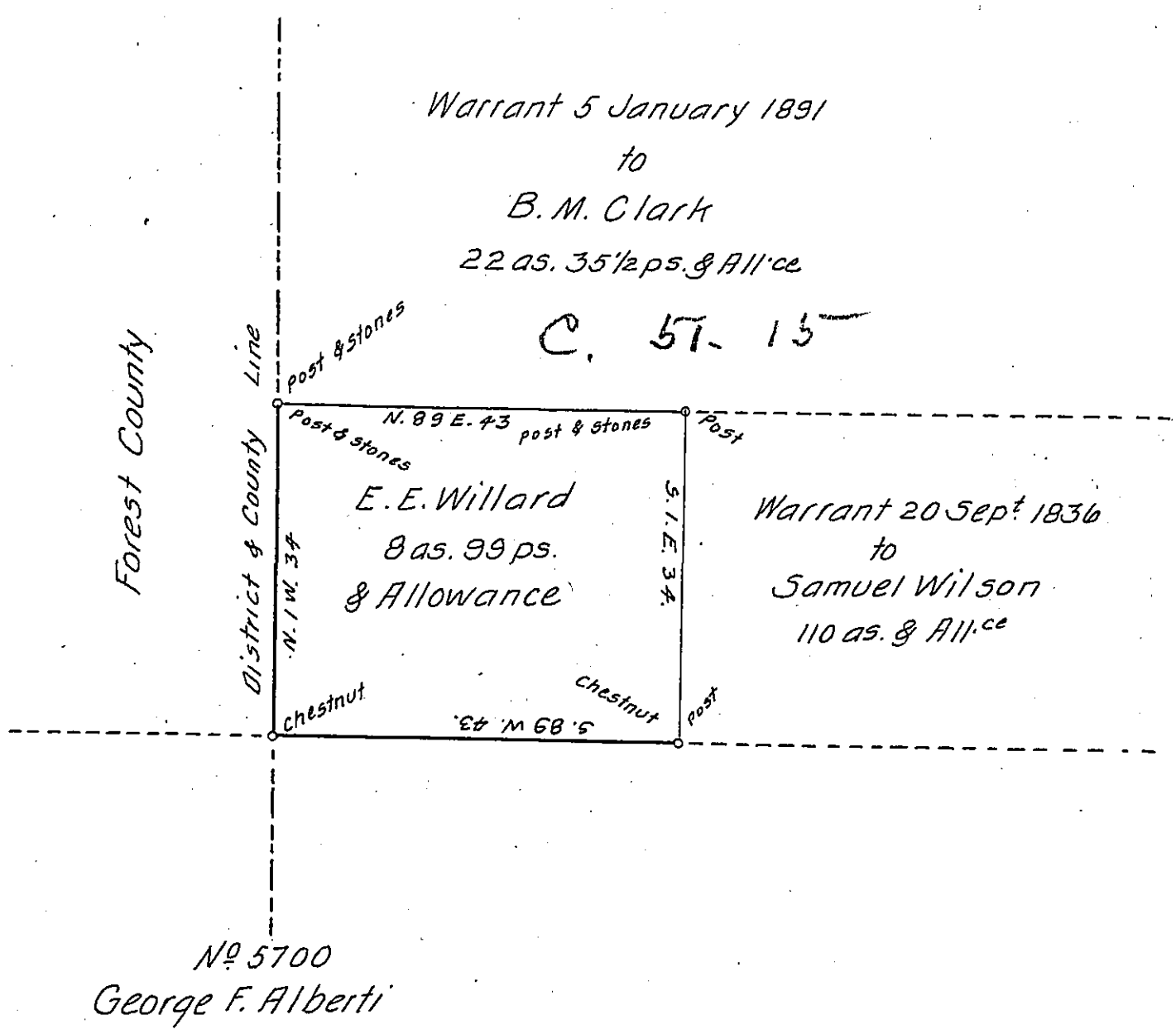
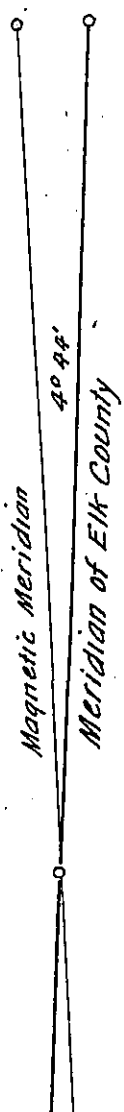

A Draft of a tract of land situated in the Township of Millstone and County of Elk, containing Eight acres, Ninety Nine perches and allowance of six per cent. for roads etc. Surveyed the Twelfth day of August 1892 in pursuance of a warrant granted to E. E. Willard dated the Second day of May 1892.

To Thomas J. Stewart, Esq., }  
Secretary of Internal Affairs } E. E. Willard  
County Surveyor.

IN TESTIMONY that the above is a copy of the original remaining on file in the Department of Internal Affairs of Pennsylvania, made conformably to an Act of Assembly approved the 16th day of February, 1833, I have hereunto set my Hand and caused the Seal of said Department to be affixed at Harrisburg, this fourteenth day of November 1907.

*Henry Howard*  
Secretary of Internal Affairs.